

SHIMANO

ULTEGRA XSC

S A-RB

UL-10000XSC

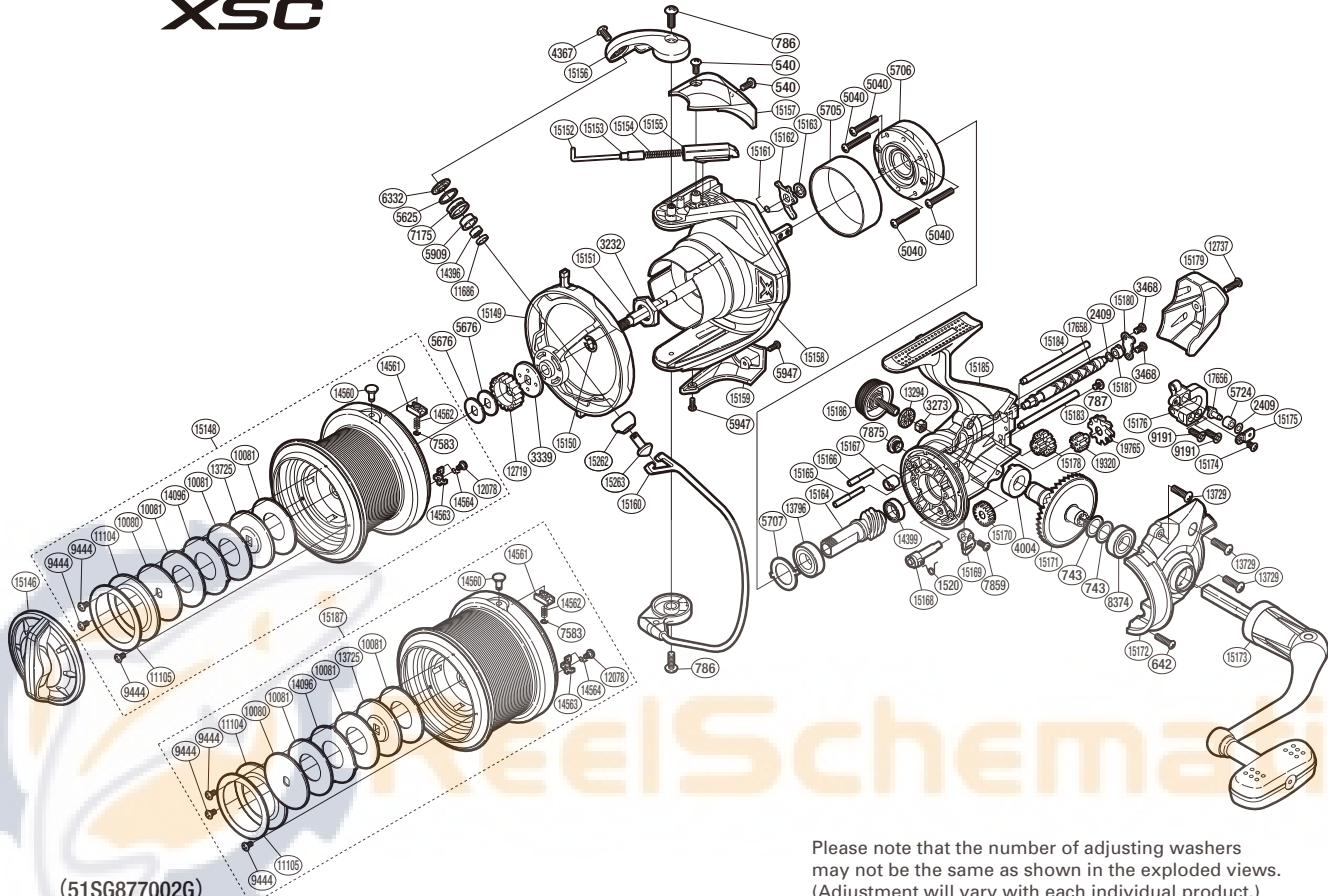

Please note that the number of adjusting washers may not be the same as shown in the exploded views. (Adjustment will vary with each individual product.)

| Part No. | Description | Part No. | Description | Part No. | Description |
|----------|----------------------------|----------|-----------------------------|----------|---------------------------|
| RD 0540 | Screw | RD11104 | Seal Plate A | RD15161 | Lever Spring |
| RD 0642 | Screw | RD11105 | Seal Plate B | RD15162 | Bail Trip Lever |
| RD 0743 | Washer | RD11686 | Bearing Spacer | RD15163 | Washer |
| RD 0786 | Screw | RD12078 | Screw | RD15164 | Pinion Gear |
| RD 0787 | Screw | RD12719 | Spool Support A | RD15165 | Idle Gear B Shaft |
| RD 1520 | Anti-Reverse Cam Spring | RD12737 | Screw | RD15166 | Idle Gear C Shaft |
| RD 2409 | Spacer | RD13294 | Handle Screw Lock Washer | RD15167 | Worm Bushing (front) |
| RD 3232 | Rotor Nut | RD13725 | Key Washer | RD15168 | Anti-Reverse Cam |
| RD 3273 | Handle Screw Lock | RD13729 | Screw | RD15169 | Anti-Reverse Lever |
| RD 3339 | Spool Support B | RD13796 | Ball Bearing | RD15170 | Idle Gear |
| RD 3468 | Screw | RD14096 | Eared Washer | RD15171 | Drive Gear |
| RD 4004 | Drive Gear Bushing | RD14396 | Ball Bearing | RD15172 | Side Cover |
| RD 4367 | Screw | RD14399 | Ball Bearing | RD15173 | Handle Assembly |
| RD 5040 | Screw | RD14560 | Line Clip | RD15174 | Screw |
| RD 5625 | Line Roller Spacer | RD14561 | Line Clip Holder | RD15175 | Oscillating Pawl Cover |
| RD 5676 | Spool Washer | RD14562 | Line Clip Spring | RD15176 | Oscillating Slider |
| RD 5705 | Roller Clutch Ring | RD14563 | Drag Click | RD15178 | Idle Gear C |
| RD 5706 | Roller Clutch Assembly | RD14564 | Drag Click Spring | RD15179 | Rear Protector |
| RD 5707 | Bearing Washer | RD15146 | Drag Knob | RD15180 | Worm Shaft Retainer |
| RD 5724 | Oscillating Slider Bushing | RD15148 | Spool Assembly | RD15181 | Worm Bushing (rear) |
| RD 5909 | Line Roller Bushing | RD15149 | Line Safety Guard | RD15183 | Oscillating Guide A |
| RD 5947 | Screw | RD15150 | E Lock | RD15184 | Oscillating Guide B |
| RD 6332 | Line Roller Washer | RD15151 | Main Shaft | RD15185 | Body |
| RD 7175 | Line Roller | RD15152 | Bail Spring Guide A | RD15186 | Handle Screw Cap |
| RD 7583 | E Lock | RD15153 | Bail Spring Guide A Support | RD15262 | Line Roller Support Cover |
| RD 7859 | Screw | RD15154 | Bail Spring | RD15263 | Line Roller Support |
| RD 7875 | Oil Cap | RD15155 | Bail Spring Guide B | RD17656 | Oscillating Pawl |
| RD 8374 | Ball Bearing | RD15156 | Bail Arm | RD17658 | Worm Shaft |
| RD 9191 | Screw | RD15157 | Bail Spring Cover | RD19320 | Idle Gear B Small |
| RD 9444 | Screw | RD15158 | Rotor | RD19765 | Idle Gear B |
| RD10080 | Key Washer | RD15159 | Bail Hold Support Guard | | |
| RD10081 | Drag Washer | RD15160 | Bail Assembly | RD15187 | Spare Spool Assembly |